

Mobilné výpočty

Ing. Maroš Čavojský, PhD.

Dizajn

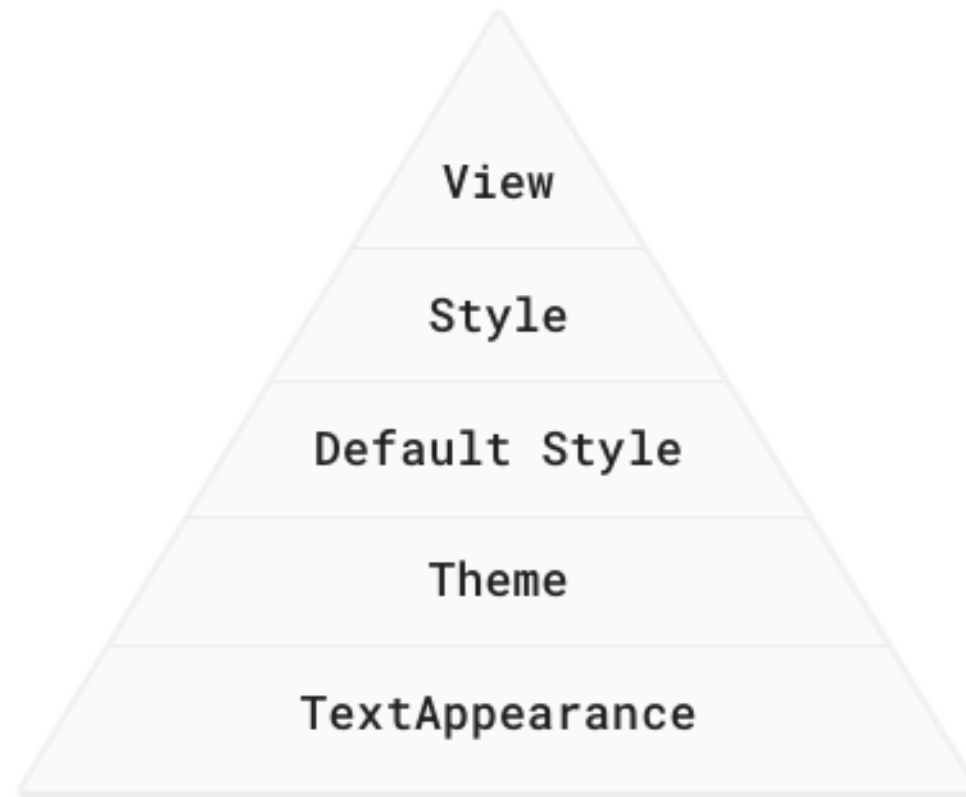

View

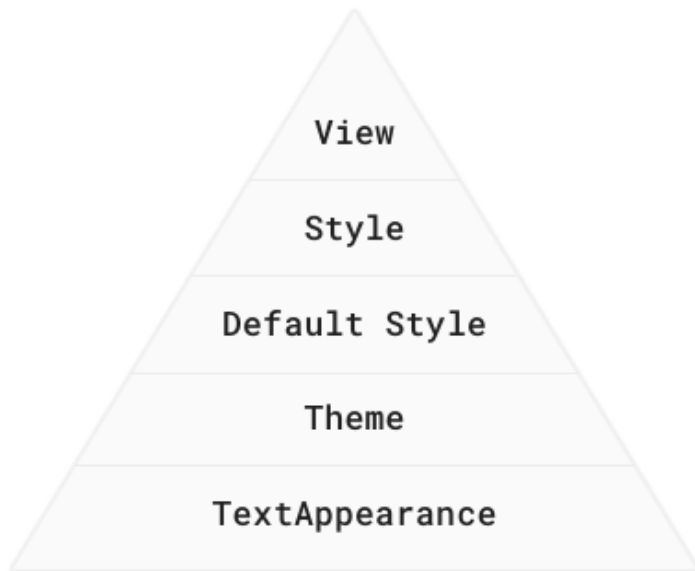

<Button

```
    android:id="@+id/login_button"  
    android:layout_width="wrap_content"  
    android:layout_height="wrap_content"  
    android:textSize="12sp"  
    android:textColor="#008577"
```

... />

View

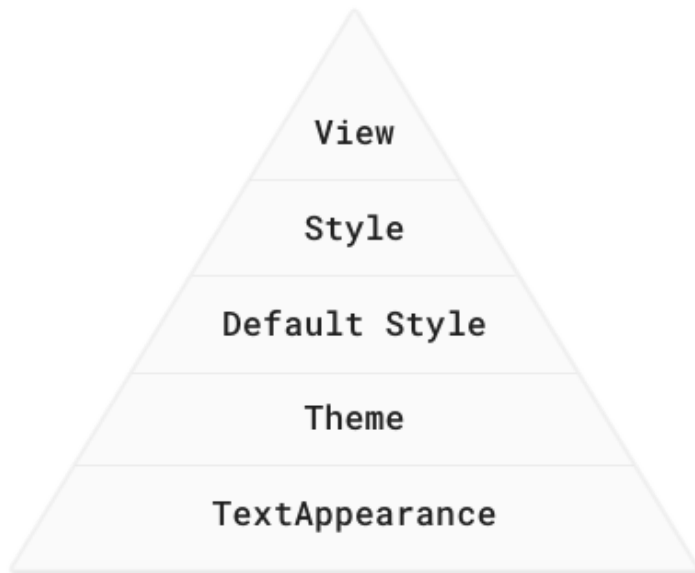

<Button

```
android:id="@+id/login_button"  
android:layout_width="wrap_content"  
android:layout_height="wrap_content"  
android:textSize="@dimen/textMedium"  
android:textColor="@color/colorPrimary"
```

.../>

```
<dimen name="textSmall">11sp</dimen>  
<dimen name="textMedium">12sp</dimen>  
<dimen name="textBig">14sp</dimen>
```

```
<color name="colorPrimary">#008577</color>  
<color name="colorPrimaryDark">#00574B</color>  
<color name="colorAccent">#D81B60</color>
```

Style



```
<Button
    android:id="@+id/login_button"
    android:layout_width="wrap_content"
    android:layout_height="wrap_content"
    style="@style/Text"
.../>
```

```
<style name="Text" parent="TextAppearance.AppCompat">
    <item name="android:textColor">@color/colorPrimary</item>
    <item name="android:textSize">@dimen/textMedium</item>
</style>
```

Default Style



Predvolené systémom

Theme

```
<style name="AppTheme" parent="Theme.AppCompat.Light.NoActionBar">  
  <!-- Customize your theme here. -->  
  <item name="colorPrimary">@color/colorPrimary</item>  
  <item name="colorPrimaryDark">@color/colorPrimaryDark</item>  
  <item name="colorAccent">@color/colorAccent</item>  
</style>
```



```
<application  
  android:theme="@style/AppTheme.Launcher"  
  ... >  
  <activity android:name=".MainActivity">  
    <intent-filter>  
      <action android:name="android.intent.action.MAIN"/>  
  
      <category android:name="android.intent.category.LAUNCHER"/>  
    </intent-filter>  
  </activity>  
</application>
```

TextAppearance

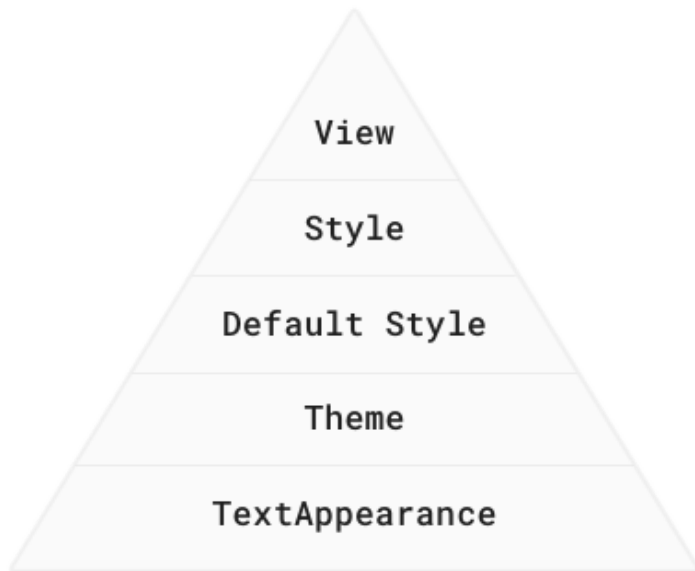

```
<Button
```

```
    android:id="@+id/login_button"
```

```
    android:layout_width="wrap_content"
```

```
    android:layout_height="wrap_content"
```

```
    android:textAppearance="?attr/Text"
```

```
.../>
```



Accessibility Scanner

Google LLC

Tools

INSTALL



Accessibility



Volume key shortcut
Off

DOWNLOADED SERVICES



Accessibility Scanner

Off / Developer testing tool

Turn on Accessibility Scanner

Selecting OK will take you to your device's Accessibility Settings.

CANCEL

OK



Accessibility Scanner

Use service





12 suggestions



Element 1

`com.example.android.gdgfinder:id/textView9`

Text contrast



Consider increasing this item's text foreground to background contrast ratio.

Element 2

`com.example.android.gdgfinder:id/EditTextName`

Item label



This item may not have a label readable by screen readers.



Touch target



Consider making this clickable item larger.

Viac info

- [10.1: Styles and themes](#)
- [10.2 Material Design, dimensions, and colors](#)
- [10.3 Design for everyone](#)

Zadanie

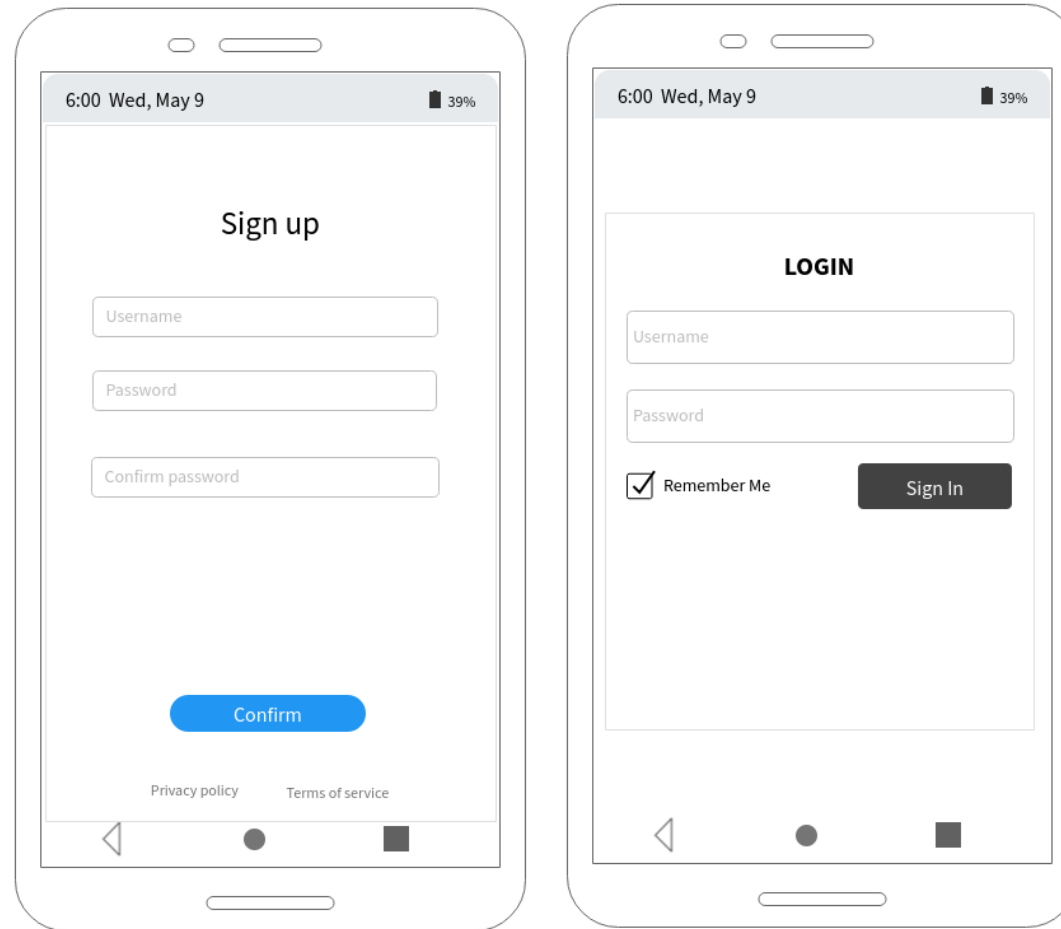

Zadanie

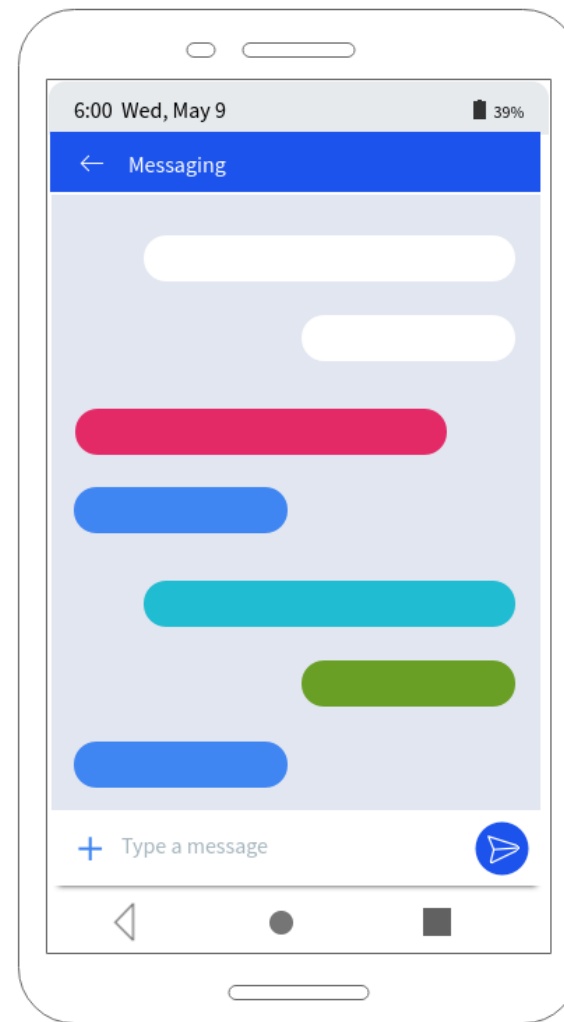
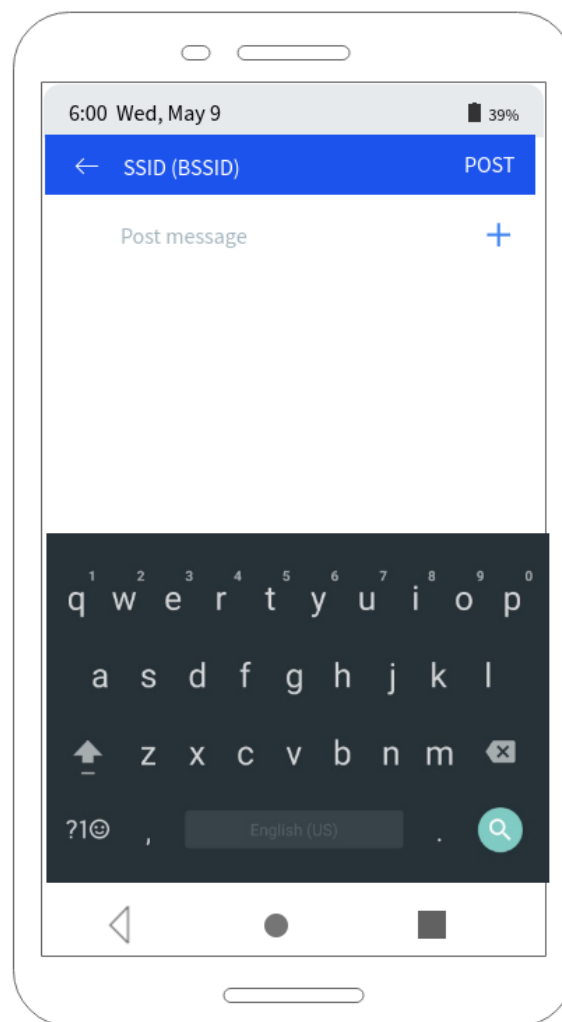
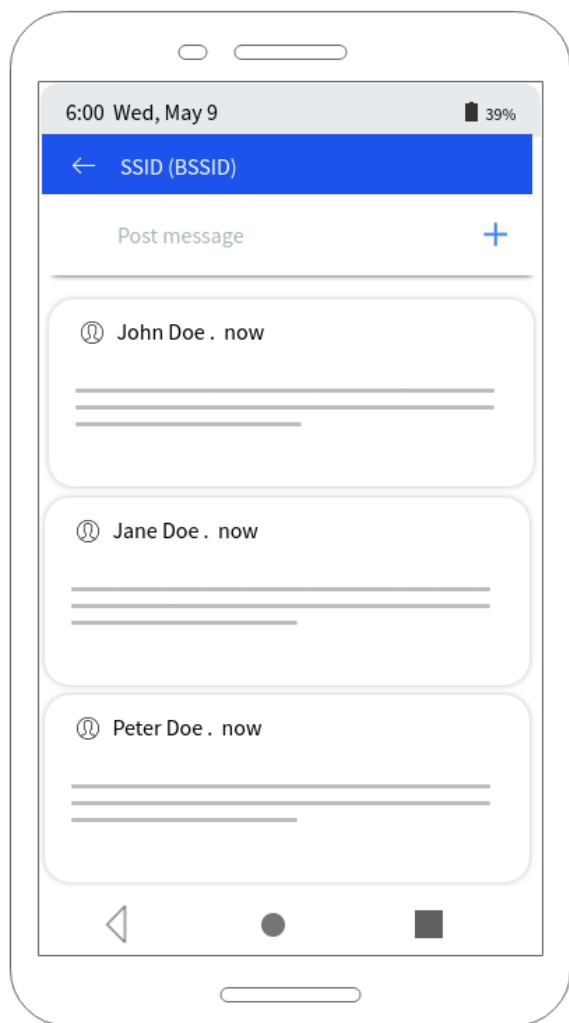

Zadanie

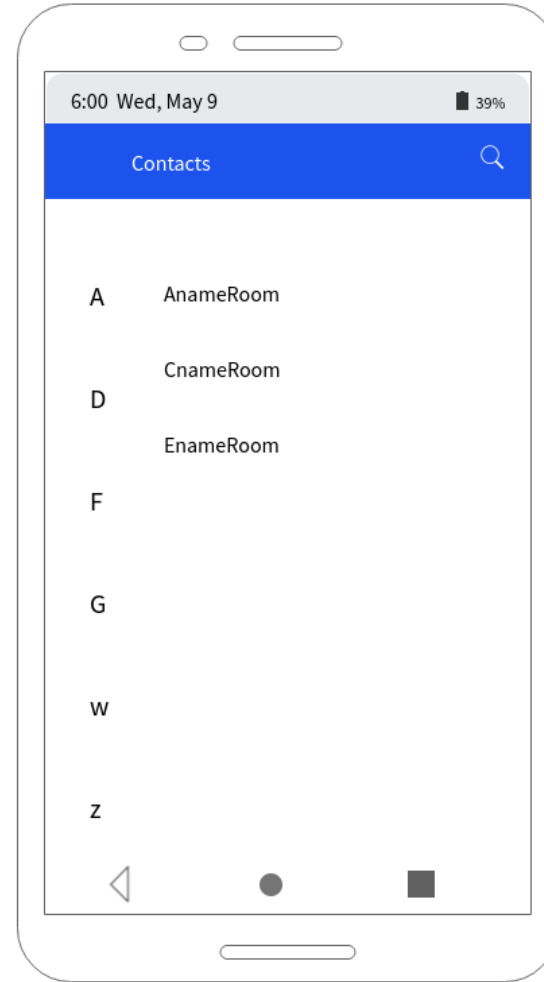
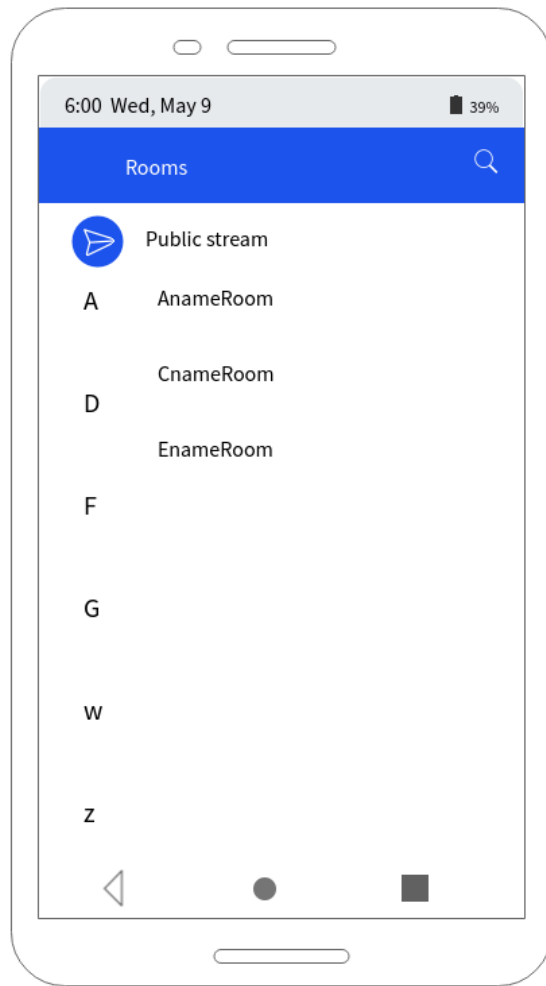

WifiManager

getConnectionInfo

Added in API level 1

```
public WifiInfo getConnectionInfo ()
```

Return dynamic information about the current Wi-Fi connection, if any is active.

In the connected state, access to the SSID and BSSID requires the same permissions as `getScanResults()`. If such access is not allowed, `WifiInfo#getSSID` will return "`<unknown ssid>`" and `WifiInfo#getBSSID` will return "`02:00:00:00:00:00`".

Returns

`WifiInfo`

the Wi-Fi information, contained in `WifiInfo`.

WifiInfo

getBSSID

Added in API level 1

```
public String getBSSID ()
```

Return the basic service set identifier (BSSID) of the current access point.

The BSSID may be `null`, if there is no network currently connected. `"02:00:00:00:00:00"`, if the caller has insufficient permissions to access the BSSID.

Returns

`String`

the BSSID, in the form of a six-byte MAC address: `XX:XX:XX:XX:XX:XX`

WifiInfo

getSSID

Added in API level 1

```
public String getSSID ()
```

Returns the service set identifier (SSID) of the current 802.11 network.

If the SSID can be decoded as UTF-8, it will be returned surrounded by double quotation marks. Otherwise, it is returned as a string of hex digits. The SSID may be <unknown ssid>, if there is no network currently connected or if the caller has insufficient permissions to access the SSID.

Prior to `Build.VERSION_CODES.JELLY_BEAN_MR1`, this method always returned the SSID with no quotes around it.

Returns

`String`

the SSID.

Viac info

- Repository pattern = Room + Retrofit + Gson + ViewModel + OAuth
- RecyclerView
- Giphy API
- WiFiManager
- Firebase Cloud Messaging (spoločný projekt)

Mobilné výpočty

Ing. Maroš Čavojský, PhD.

maros.cavojsky@stuba.sk

C606